

JB Stephens Sensory Garden  
Club  
Parent Permission Slip

\_\_\_\_\_  
Student's Name

\_\_\_\_\_  
Student's grade

\_\_\_\_\_  
Teacher's name

\_\_\_\_\_  
Parent's email

\_\_\_\_\_  
Parent's cell phone number

I give my child permission to participate in the JB Stephens Sensory Garden Club.

\_\_\_\_\_  
Parent signature

My child is interested in attending the following days:

\_\_\_ April 3, 2019, 2-3:00 p.m.

\_\_\_ April 16, 2019, 2-3:00 p.m.

\_\_\_ May 1, 2019, 2-3:00 p.m.

\_\_\_ May 14, 2019, 2-3:00 p.m.

\_\_\_ May 29, 2019, 2-3:00 p.m.

We will notify you as to when your child may attend. Cut and return this portion to the front office.



Be a part of the JB Stephens Sensory Garden Club. This is not like other clubs because you do not need to come to all the meetings. In fact we only have about six students attend each meeting and planting day. We must have parent permission to join. Then you request which day you can stay and help.

**Sensory Garden Committee**

Leah Bewley, Kindergarten Teacher & School Contact

Darlene Trusty, Committee Chairman & Master Gardener

Shane Bryant, Principal

Connie Dickinson, Master Gardener

Brenda Hayes, Master Gardener

Rosemary Hill, Master Gardener

Peggy Robertson, Master Gardener

Thomas Yazell, Master Gardener Intern

Linda Lee Thompson, School Volunteer

JB Stephens Sensory Garden

Leah Bewley, School Contact  
317-462-4491

Email: lbewley@gcsc.k12.in.us

JB Stephens Elementary School



It's here!!

► JB Stephens  
Sensory Garden  
Spring 2019

**School Contact:**  
**Leah Bewley**  
**JB Stephens Elementary School**  
**1331 North Blue Road**  
**Greenfield, IN 46140**

**317-462-4491**

# Sensory Garden Meeting Dates

**Open house tour - STEM Night 2019 - Thursday, May 16, 5:30-7:30 p.m. - Come visit our garden!**

**Spring 2019 Planting & Maintenance Days**

**Wednesday, April 3, 2019, 2:00-3:00 p.m. - Touring garden, clean up and maintenance, plant seeds to grow inside**

**Tuesday, April 16, 2019, 2:00-3:00 p.m. - Plant snapdragons and pansies, clean up and maintenance**

**Wednesday, May 1, 2019, 2:00-3:00 p.m. - Plant tomatoes & strawberries, clean up and maintenance**

**Tuesday, May 14, 2019, 2:00-3:00 p.m. - plant inpatients, hellebores and other plants that didn't survive winter, clean up and maintenance**

**Wednesday, May 29, 2019, 2:00-3:00 p.m. - plant seedlings from April 3rd and other plants that didn't survive winter, clean up and maintenance**

Come and join in the fun!

## Explore the 5 Senses

The sensory garden at JB Stephens is located across the library in the atrium. In this garden we will carefully grow plants that appeal to the five senses: sight, touch, taste, smell and sound. With the help of the school's staff, students and parents and the Hancock County Master Gardeners, children will have great fun learning about plants that awaken their five senses. This is their chance to get dirty for a reason!



Leah Bewley  
School Contact  
317-462-4491  
Email: lbewley@gcsc.k12.in.us

JB Stephens  
Sensory Garden

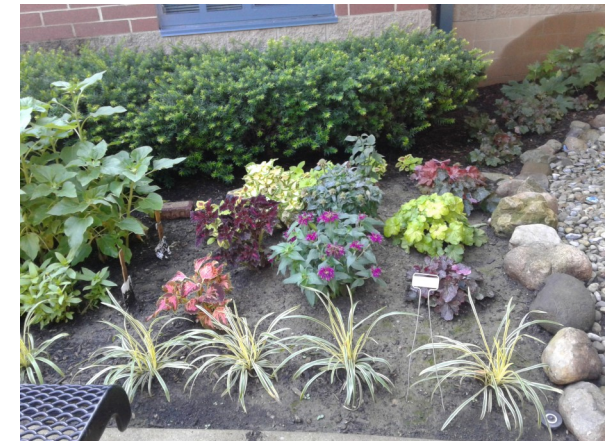

Purdue University Cooperative Extension Service is an equal access/equal opportunity institution. .